

SITE INFORMATION
 PARCEL ID: R06500-003-004-000
 CURRENT ZONING: RB-CD & O&I-1-CD
 PROPOSED USE: MIXED USE
 OWNER INFORMATION: BARCLAY COMMONS RETAIL, LLC,
 2508 INDEPENDENCE BLVD, SUITE 202
 WILMINGTON, NC

LANDSCAPE NOTES:

- CONTRACTOR IS RESPONSIBLE FOR IDENTIFYING ALL UTILITIES PRIOR TO BEGINNING CONSTRUCTION.
- TREES SHALL BE LOCATED A MINIMUM OF 5 FEET FROM SEWER/WATER CONNECTIONS OR AS OTHERWISE DICTATED BY LOCAL REGULATIONS. CONTRACTOR SHALL BE LIABLE FOR DAMAGE TO ANY AND ALL PUBLIC OR PRIVATE UTILITIES.
- STAKE ALL TREES AS SHOWN IN DETAIL CR AS OTHERWISE DIRECTED BY OWNER OR OWNER'S REPRESENTATIVE.
- ALL PLANT MATERIAL SHALL MEET THE CURRENT VERSION OF THE AMERICAN ASSOCIATION OF NURSERYMEN'S STANDARDS.
- NO EXISTING TREES SHALL BE REMOVED WITHOUT WRITTEN AUTHORIZATION FROM THE LANDSCAPE ARCHITECT OR OWNER'S REPRESENTATIVE.
- SET ALL TREES IN 5" MINIMUM DIAMETER PINE STRAW MULCH BED.
- ALL SHRUB BEDS AND/OR PLANTING AREAS EXCLUDING SEEDED AREAS SHALL BE MULCHED WITH 3 INCH MINIMUM AND 4 INCH MAXIMUM DEPTH PINE STRAW MULCH UNLESS OTHERWISE NOTED.
- PLANTING SOIL MIX: MIX EXISTING SOIL WITH THE SOIL AMENDMENTS AND FERTILIZERS IN THE QUANTITIES RECOMMENDED BY THE SOIL TESTING LABORATORY, THIRD PARTY RECOGNIZED BY THE STATE DEPARTMENT OF AGRICULTURE OR AS OTHERWISE APPROVED BY THE LANDSCAPE ARCHITECT OR OWNER'S REPRESENTATIVE.
- ANY AND ALL SUBSTITUTIONS OF PLANT MATERIAL SHALL BE APPROVED BY LANDSCAPE ARCHITECT OR OWNER'S REPRESENTATIVE. FAILURE IN OBTAINING APPROVAL MAY RESULT IN LIABILITY TO THE CONTRACTOR.
- THE CONTRACTOR SHALL REPLACE DEAD AND/OR UNHEALTHY PLANT MATERIAL WITHIN 12 MONTHS OF ACCEPTANCE OF THE INSTALLED MATERIAL FROM THE OWNER OR OWNER'S REPRESENTATIVE.
- THE CONTRACTOR SHALL PREPARE ALL SEEDED AREAS TO ASSURE THAT THE SUBGRADE HAS BEEN RAKED AND ROLLED TO ACCEPT THE SEED. ALL TURF AREAS MUST BE IRRIGATED OR HAND WATERED. ALL TURF AREAS SHOULD PROVIDE A SMOOTH SURFACE FREE OF DIPS AND UNLEVELED GROUND. REFERENCE PLANT SCHEDULE FOR TURF SELECTION.
- IRRIGATION SHALL BE DESIGNED AND INSTALLED BY A LICENSED IRRIGATION CONTRACTOR IN THE STATE OF NORTH CAROLINA.
- THE CONTRACTOR IS RESPONSIBLE FOR HAND WATERING THE INSTALLED PLANT MATERIAL FOR A PERIOD OF 6 MONTHS FROM THE ACCEPTANCE FROM THE OWNER OR OWNER'S REPRESENTATIVE IF IRRIGATION HAS NOT BEEN INSTALLED. ALL MATERIAL INCLUDING TURF AREAS SHALL BE HAND WATERED ONCE WEEKLY OR AS NEEDED TO ENSURE SURVIVAL OF PLANTS.
- CONTRACTOR IS RESPONSIBLE FOR REMOVING TRASH, DEBRIS AND EXCESS MATERIALS FROM THE JOB SITE ONCE THE PROJECT IS COMPLETE. SECURING ANY MATERIALS LEFT ON SITE DURING THE COURSE OF THE PROJECT IS THE CONTRACTOR'S RESPONSIBILITY.
- STREET TREES WILL BE PLANTED AS CLOSE TO CITY REGULATIONS AS POSSIBLE; HOWEVER, SITE CONDITIONS INCLUDING THE LOCATIONS OF DRIVEWAYS, SIGNS, ETC. MAY REQUIRE ADJUSTMENT FROM PROPOSED PLAN.
- ALL PROPOSED VEGETATION WITHIN SIGHT DISTANCE TRIANGLES SHALL NOT INTERFERE WITH CLEAR VISUAL SIGHT LINES FROM 30' - 10' IN ACCORDANCE WITH SECTION 18-556 OF THE CITY OF WILMINGTON LAND DEVELOPMENT CODE.
- ANY TREES NEAR ROADWAYS AND WALKWAYS BUT LOCATED OUTSIDE OF DESIGNATED SIGHT DISTANCE TRIANGLES WILL BE MAINTAINED TO PROVIDE CLEAR SIGHT LINES UP TO 10'.
- IN CASES WHERE SIGHT DISTANCE TRIANGLES INTERFERE WITH OTHER REQUIRED BUFFER OR PLANTING AREAS, THE SIGHT DISTANCE TRIANGLE WAS MAINTAINED AND PLANTINGS WERE ADJUSTED TO ALLOW FOR PROPER SIGHT LINES.
- AUTOMATIC IRRIGATION SYSTEM TO BE PROVIDED BY OWNER.
- TREES SHALL BE PLANTED NO LESS THAN 5' FROM SEWER AND WATER LINES.
- ALL LANDSCAPE PLANTINGS WILL BE COMPLIANT WITH ARTICLE 8 OF THE CITY OF WILMINGTON LDC.
- IF OWNER REQUESTS ADDITIONAL PLANTINGS WITHIN SIGHT TRIANGLES, ALL PLANTINGS WILL BE LIMITED TO SHRUBS AND/OR ORNAMENTAL GRASSES LESS THAN 30" IN HEIGHT.

LANDSCAPE CALCULATIONS:

SHADING REQUIREMENTS:
 PH 1 REQUIRED: 23.6 AC X 0.20 = 4.72 AC
 PH 1 PROVIDED: 5.59 AC OR 243,828 SF
 PH 2 BLDG 9 & 10 REQUIRED: 1.07 AC X 0.20 = 0.21 AC
 PH 2 BLDG 9 & 10 PROVIDED: 21 LARGE CANOPY @ 707 SF = 14,847 SF OR 0.34 AC
 ALL COMBINED PHASES:
 REQUIRED: 4.72 AC + 0.15 AC = 4.87 AC
 PROVIDED: 5.59 AC + 0.34 AC = 5.93 AC

*SHADING REQUIREMENTS SHOWN FOR REFERENCE ONLY. NO NEW TREES HAVE BEEN ADDED TO SATISFY SHADING REQUIREMENTS SINCE ALL PAVING AND PARKING AREAS ARE EXISTING.

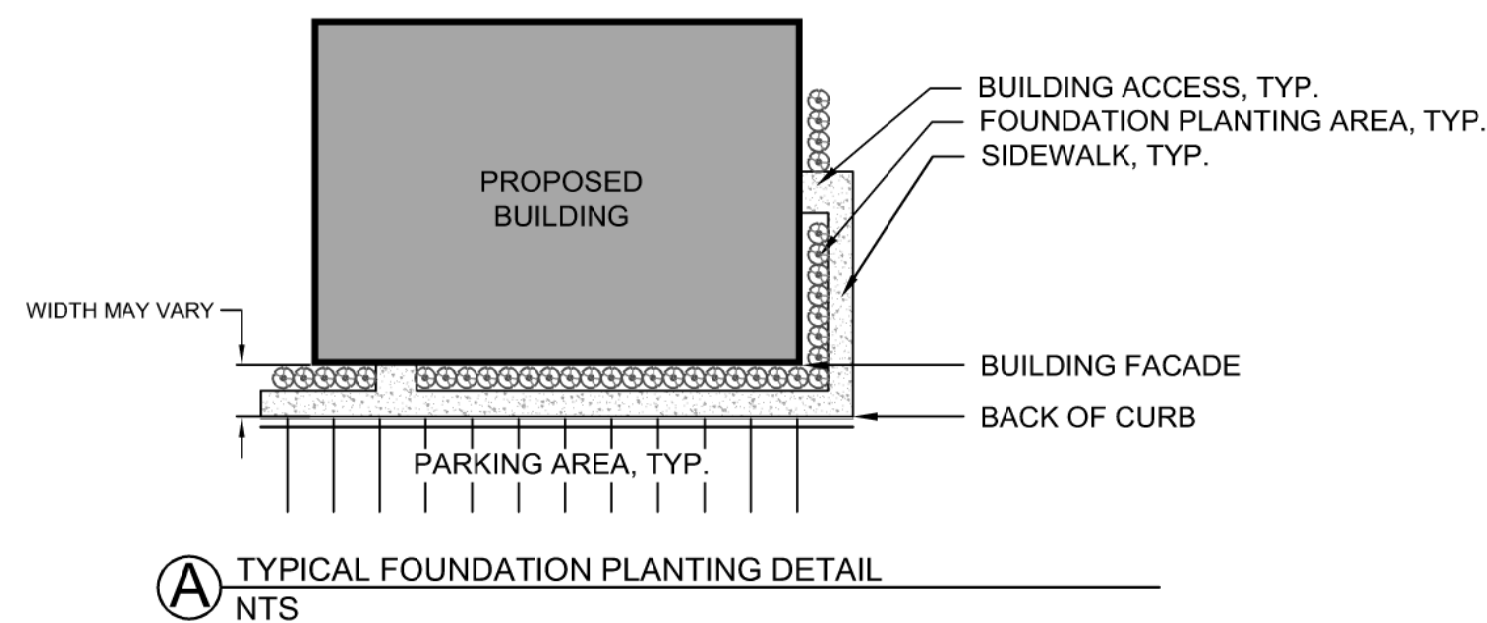

FOUNDATION PLANTING NOTES:

- LOCATION OF 1/2' HGT. PLANTINGS MAY VARY BASED ON BUILDING AND SITE DESIGN
- LANDSCAPING TO BE LOCATED BETWEEN THE BACK OF CURB AND BUILDING FACADE.
- ALL FOUNDATION PLANTINGS SHALL BE COMPLIANT WITH ARTICLE 8 SECTION 18-490 OF THE CITY OF WILMINGTON LDC PRIOR TO RECEIVING A CERTIFICATE OF OCCUPANCY.

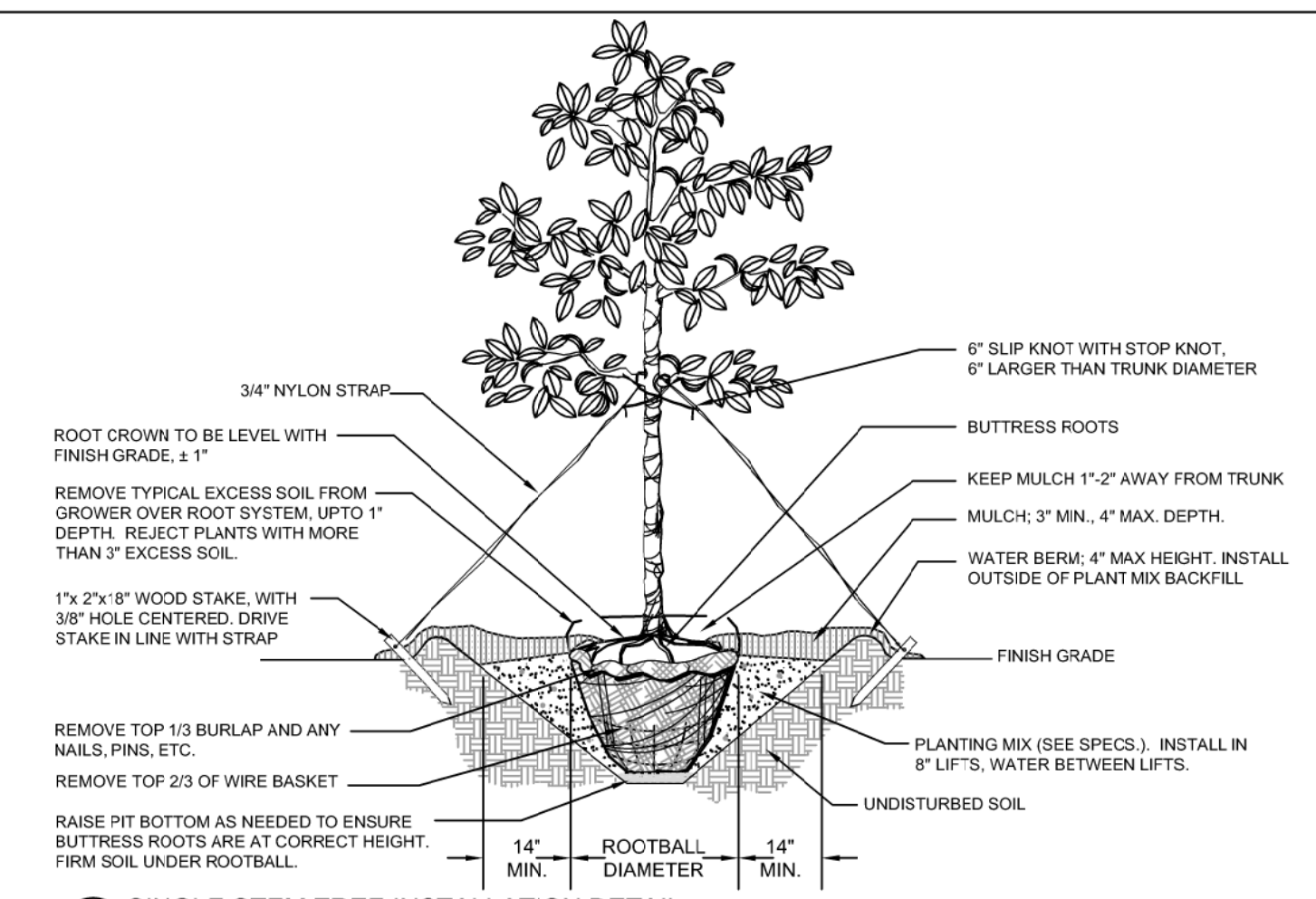

NOTES:

- OMIT COLLAR AROUND EACH SHRUB WHEN IRRIGATION SYSTEM IS PRESENT.
- INSTALL TOP OF PLANT BALL 2" ABOVE ADJACENT GRADE.
- TAMP PLANT SOIL MIX FIRMLY IN 8" LIFTS AROUND PLANT BALL.
- SOAK PLANT BALL AND PIT IMMEDIATELY AFTER INSTALLATION.

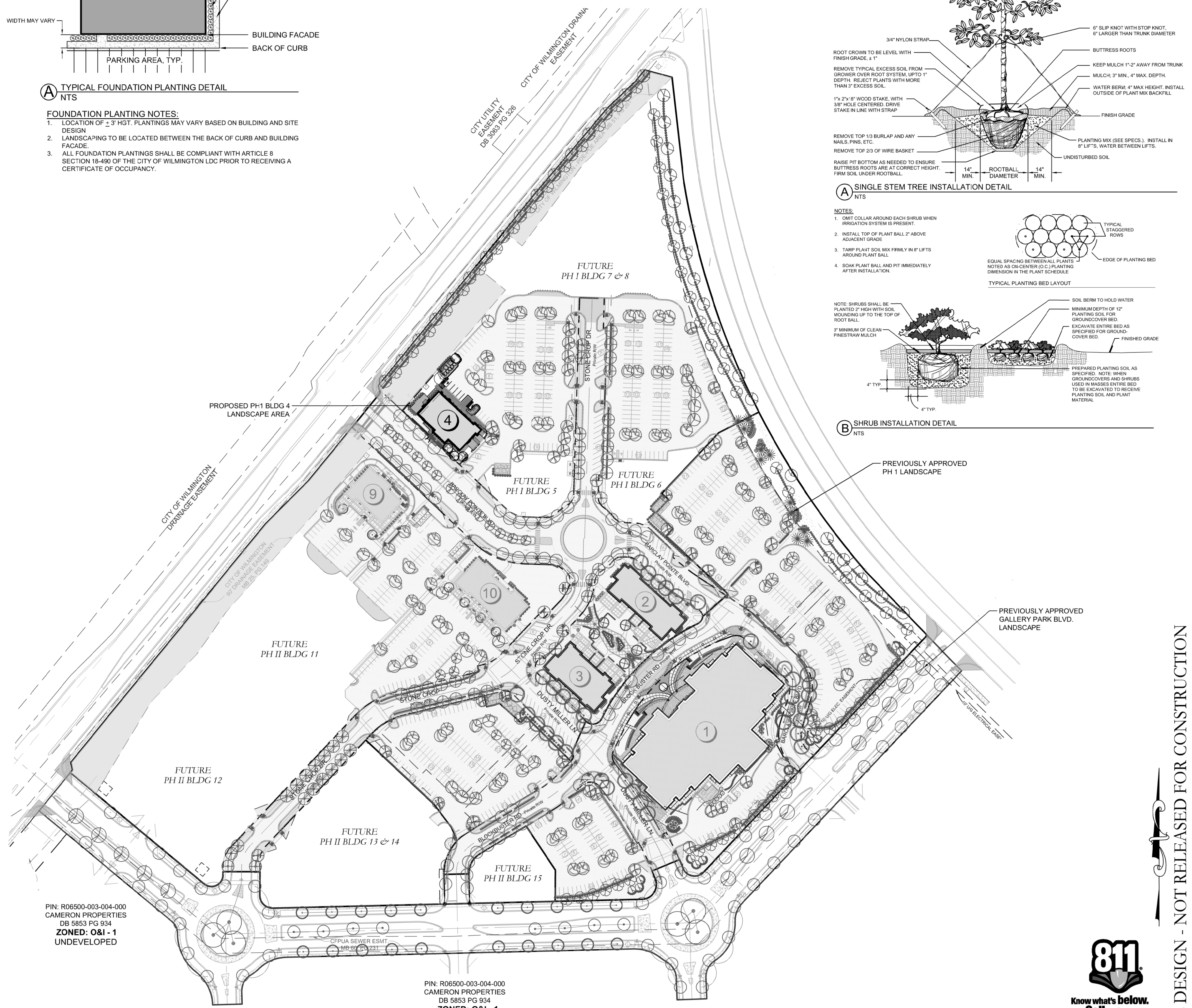
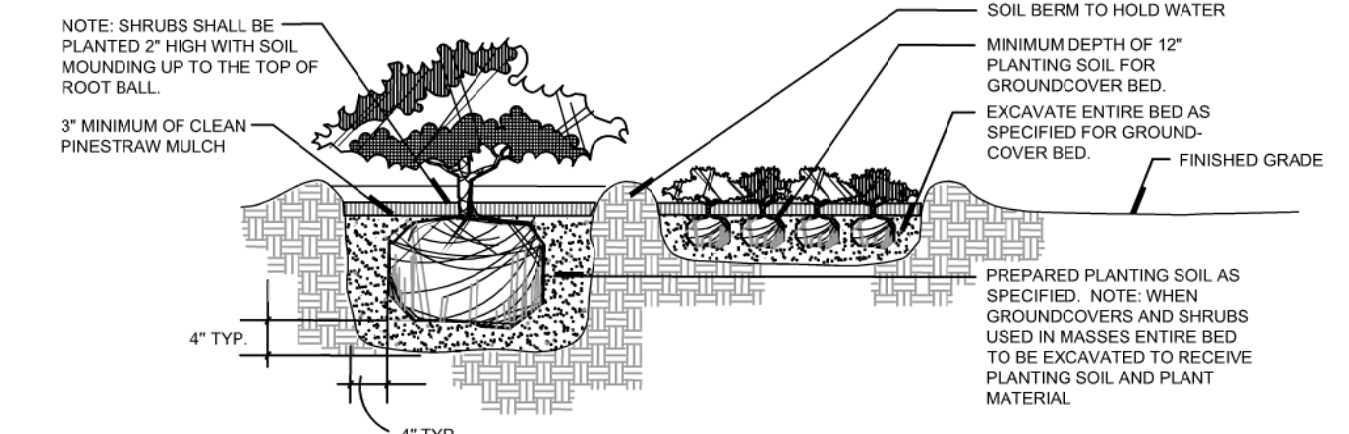

For each open utility cut of City streets, a \$325 permit shall be required from the City prior to occupancy and/or project acceptance.

PIN: R06500-003-004-000
 CAMERON PROPERTIES
 DB 5853 PG 934
 ZONED: O&I - 1
 UNDEVELOPED

PIN: R06500-003-004-000
 CAMERON PROPERTIES
 DB 5853 PG 934
 ZONED: O&I - 1
 UNDEVELOPED

Approved Construction Plan

Name	Date
Planning	
Traffic	
Fire	

CITY OF WILMINGTON
 NORTH CAROLINA
 Public Services • Engineering Division
 APPROVED STORMWATER MANAGEMENT PLAN

Date: _____ Permit # _____
 Signed: _____

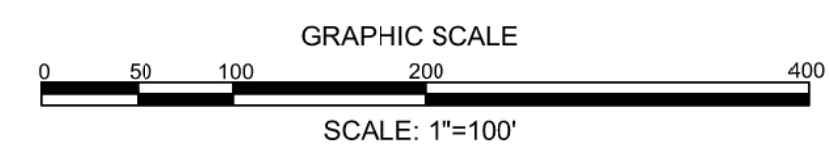

FINAL DESIGN - NOT RELEASED FOR CONSTRUCTION

REVISIONS:

REV. 1	REVISED PER TRC COMMENTS
REV. 2	REVISED PER TRC COMMENTS

CLIENT INFORMATION:
Barclay Commons Retail, LLC
 1111 Metropolitan Ave., Suite 700
 Charlotte, NC 28204

PARAMOUNTE ENGINEERING
 122 Cinema Drive
 Wilmington, North Carolina 28403
 (910) 791-6707 (O) (910) 791-6700 (F)
 NC License #: C-2846

OVERALL LANDSCAPE PLAN
 THE POINTE AT BARCLAY
 PHASE I - BUILDING 4
 BARCLAY WEST TRACT 'B'
 CITY OF WILMINGTON
 NORTH CAROLINA

PROJECT STATUS:
 CONCEPTUAL LAYOUT: _____
 FINAL LAYOUT: _____
 FINAL DESIGN: _____
 RELEASED FOR CONST: _____

DRAWING INFORMATION:
 DATE: 07/01/17
 SCALE: 1" = 100'
 DESIGNED: JOHN JOHNSON
 CHECKED: _____

811
 Know what's below.
 Call before you dig.

L-1.0

PEI JOB#: 14222.PE

Landscape Calculations													
Required Foundation Plantings											Provided		
Phase 1 - Building 4													
Location	Bldg. Hgt.	LF - North	North SF (LF x Bldg. Hgt. x .12)	LF - South	South SF (LF x Bldg. Hgt. x .12)	LF - East	East SF (LF x Bldg. Hgt. x .12)	LF - West	West SF (LF x Bldg. Hgt. x .12)	North SF Provided	South SF Provided	East SF Provided	West SF Provided
Building 4	24.5	120	353	-	-	64	188	68	200	369	-	189	202
Required Street Yard											Provided		
Phase 1													
Location	LF of frontage	Total SF required (Zoning Multiplier of 12.5)	Plant Multiplier (Total SF/ 600 SF)	Trees Required (Plant Multiplier x 1)	Shrubs Required (Plant Multiplier x 6)	SF Provided	Trees Provided	Shrubs Provided					
Barclay Pointe Blvd.	158	1,975	3.29	3	20	1,975	3	20					

PLANT SCHEDULE							
TREES	CODE	QTY	COMMON NAME	SIZE	SPACING	REMARKS	
	AHB	3	AMERICAN HORNBEEAM CARPINUS CAROLINIANA	2.5" CAL			
	NUT	1	NUTTALL OAK QUERCUS NUTTALLII	2.5" CAL			
SHRUBS	CODE	QTY	COMMON NAME	CONT	SPACING	REMARKS	
	DBH	27	DWARF BURFORD HOLLY ILEX CORNUTA 'BURFORDII NANA'	7 GAL			
	PIT	26	MOCK ORANGE PITTIOSPORUM TOBIRA	7 GAL			
GRASSES	CODE	QTY	COMMON NAME	CONT	SPACING	REMARKS	
	FG	7	KARLEY ROSE FOUNTAIN GRASS PENNISSETUM ORIENTALE 'KARLEY ROSE'	3 GAL			
	MG	26	PINK MUHLY MUHLENBERGIA CAPILLARIS	1 GAL			
GROUND COVERS	CODE	QTY	COMMON NAME	CONT	SPACING	SPACING	REMARKS
	ASJ	90	ASIATIC JASMINE TRACHELOSPERMUM A. 'ASIATIC'	4" POT	18" O.C.	18" o.c.	

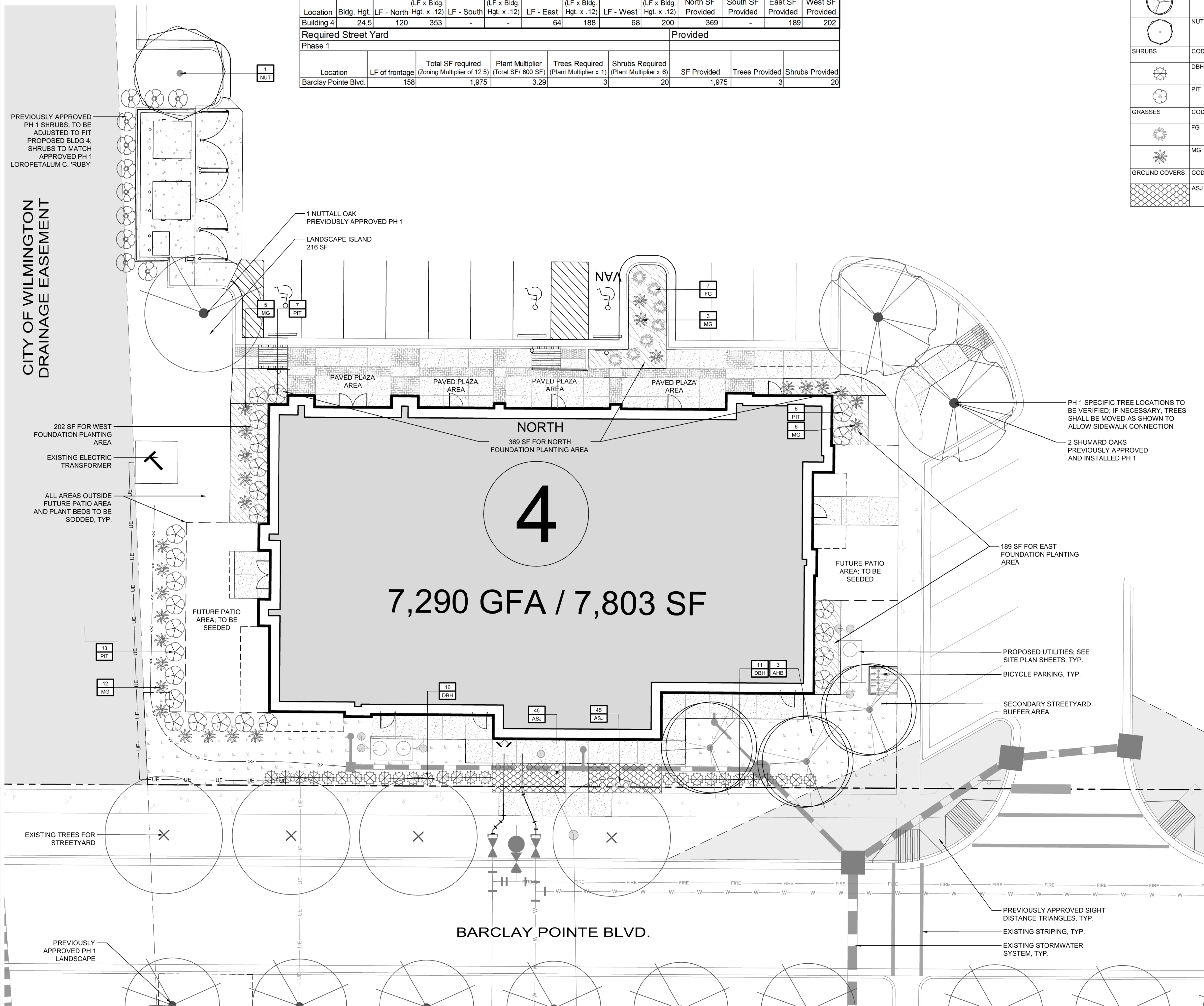

NCDENR FWSS WATER PERMIT #:	_____	GPD
WATER CAPACITY:	_____	GPD
DWQ SEWER PERMIT #:	_____	GPD
SEWER CAPACITY:	_____	GPD
SEWER SHED # AND PLANT:	_____	
SEWER TO FLOW THROUGH NEI:	YES or NO (CIRCLE ONE)	

For each open utility cut of City streets, a \$325 permit shall be required from the City prior to occupancy and/or project acceptance.

Approved Construction Plan

Name _____ Date _____

Planning _____

Traffic _____

Fire _____

WILMINGTON
NORTH CAROLINA
Public Services • Engineering Division
APPROVED STORMWATER MANAGEMENT PLAN

Date: _____ Permit # _____

Signed: _____

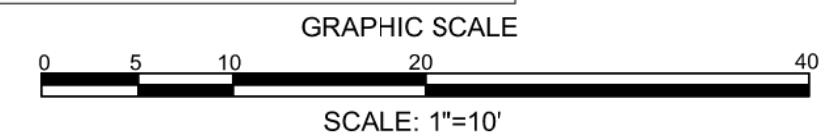

REVISIONS:

NO.	DATE	DESCRIPTION
REV. 1	09/17/17	REVISED PER TRC COMMENTS
REV. 2	09/17/17	REVISED PER TRC COMMENTS

CLIENT INFORMATION:

Barclay Commons Retail, LLC
1111 Metropolitan Ave., Suite 700
Charlotte, NC 28204

PARAMOUNT ENGINEERING
122 Cinema Drive
Wilmington, North Carolina 28403
(910) 791-6707 (O) (910) 791-6700 (F)
NC License # C-2846

LANDSCAPE PLAN
THE POINTE AT BARCLAY
PHASE I - BUILDING 4
'BARCLAY WEST TRACT B'
CITY OF WILMINGTON
NORTH CAROLINA

PROJECT STATUS:
CONCEPTUAL LAYOUT: _____
FINAL DESIGN LAYOUT: _____
RELEASED FOR CONSTRUCTION: _____

DRAWING INFORMATION:
DATE: 09/05/17
SCALE: 1"=10'
DESIGNED: JOHN A. BROWN
CHECKED: _____

SEAL:
NORTH CAROLINA
1823
09/05/17
ALAN BROWN, ENGINEER

L-1.1

PEJ JOB#: 14222.PE

FINAL DESIGN - NOT RELEASED FOR CONSTRUCTION